

FAUCET CARE AND
MAINTENANCE GUIDE

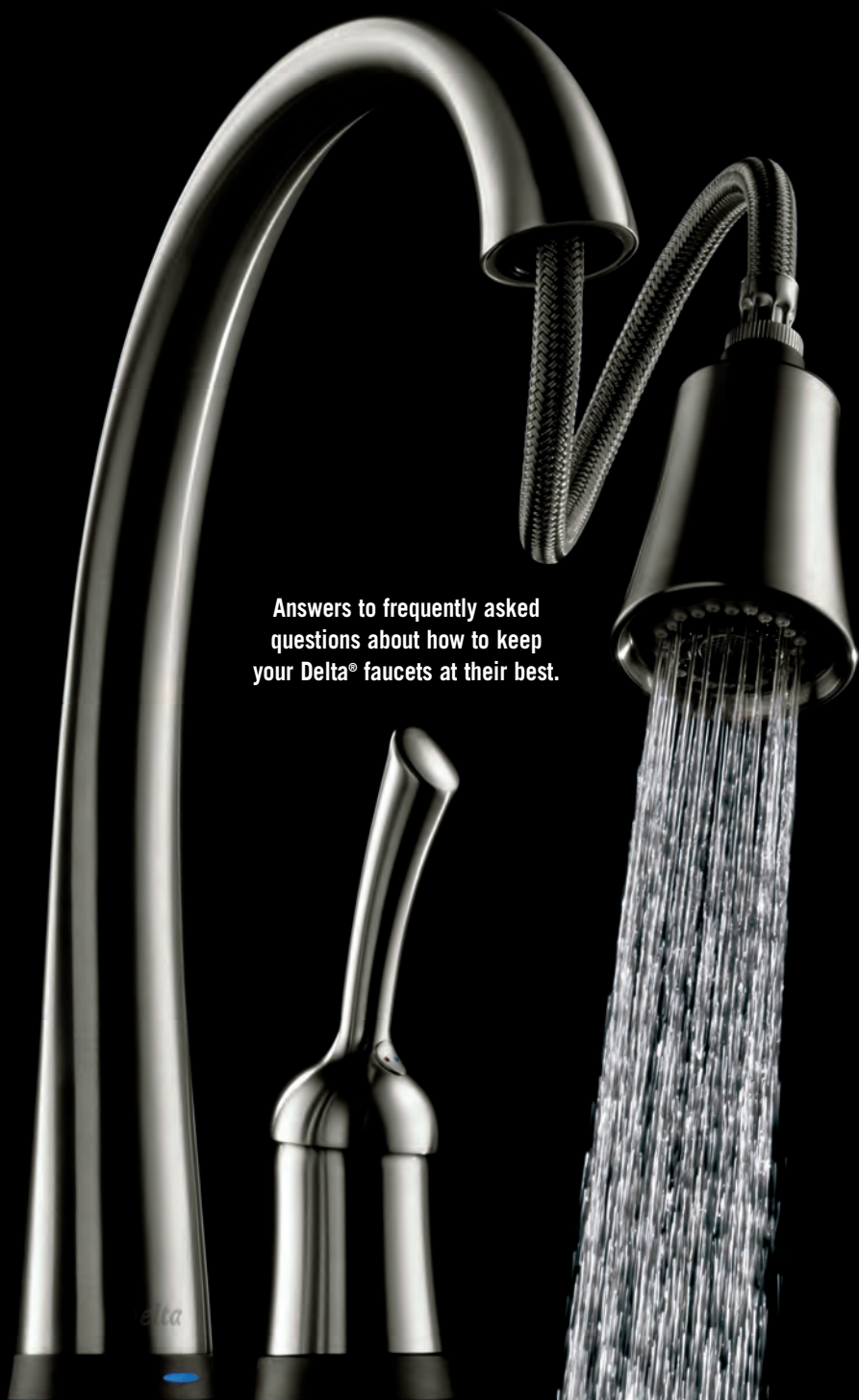

see what Delta can do™

Answers to frequently asked
questions about how to keep
your Delta® faucets at their best.



Congratulations.

You've made a smart choice.

Your new Delta® faucets are engineered for superior performance inside and out—offering thoughtful features that make a difference in your everyday life.



2 Registration

3 Early maintenance

5 Cleaning tips

7 New technologies

11 Before you call

16 Smart features

19 Faucet and finish
lifetime limited warranty

Registration.

Why register your new Delta faucets?

It is to your benefit to register your new Delta faucets. When you do, your information is entered into our proprietary database which will enable us to contact you regarding your Delta faucets should the need arise.

We respect your privacy and will *only* use the information you provide us to better serve you—it will never be sold to or used by another company or third party.

To register your Delta faucets, visit **deltafaucet.com/warranty**.

And, for more detailed care and maintenance information, visit **deltafaucet.com/customersupport**.



Early maintenance.

I just moved into a newly constructed home. What should I know about my faucets?

Even though a plumber flushes the pipes before completing work on your home, a small amount of construction debris may be flushed out of your pipe system during the first few days you use your faucets. Solder particles, copper chips, plumber tape and other installation materials can also get caught in aerators and showerheads. The tips below will help you avoid problems. It's also a good idea to follow these procedures each time the water has been turned off for repairs in your home.

To Flush a Kitchen or Lavatory Faucet:

- **Remove** aerator and black sealing gasket above it.
- **Turn** hot and cold faucet handle(s) to full on position(s) and flush lines for two minutes before turning off water.
- **Replace** aerator with black sealing gasket above it.



To Flush a Pull-Out/Pull-Down Kitchen Faucet:

If the spray does not come out of the wand as you would expect:

- **Unscrew** the wand from the hose. Aim hose into drain.
- **Turn** faucet handle to full on hot and cold mixed position and flush for two minutes to remove debris from the lines.
- **Tap** the screen in the wand to remove debris. *Note: Do not further disassemble the wand.*
- **Screw** the wand back onto the hose.

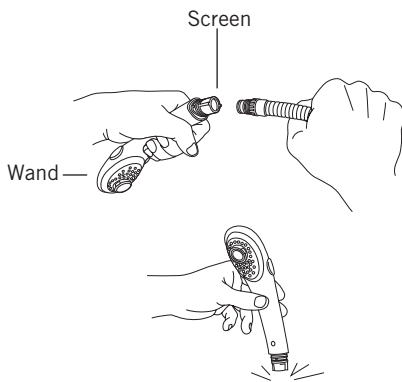



To Flush a Tub/Shower Faucet:

- **Remove** showerhead, if applicable.
- **Turn** handle(s) to full on hot and cold mixed position(s).
- **Flush** tub spout for two minutes without moving handle(s).
- **Divert** water to shower (if applicable) and flush shower arm for two minutes.
- **BE SAFE!** Make sure cold water flows FIRST and that the adjustable rotational limit stop is properly set. Visit deltafaucet.com/rotationalstop for more information on setting the adjustable rotational limit stop. Due to inlet water temperature changes, you may need to adjust it seasonally.

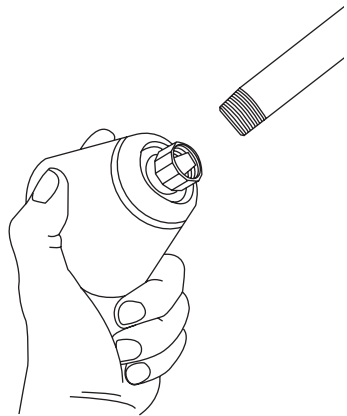

Cleaning tips.

How should I clean or maintain the finish on my faucet?

- **Wipe** your faucet with a damp cloth and mild household cleanser.
- **Dry** with a soft cloth to retain luster and shine.

What cleaning products can cause damage to faucet finishes?

Although your faucet's finish is extremely durable, it can be damaged or scratched by harsh cleaners or abrasives. Here's what to avoid:

- Industrial cleaners
- Abrasive cleaners
- Toilet bowl cleaners
- Bleach-based cleaners
- Polish
- Ammonia solutions
- Heavy-duty scrub sponges
- Products that state on the label that they remove tarnish and rust
- Products containing hydrofluoric, hydrochloric and/or phosphoric acids and caustic agents



What's the best way to remove lime and mineral deposits from my faucet?

If using a mild household cleanser doesn't do the job, place a cloth soaked in white vinegar over the deposits for several hours, then try the mild cleanser again. *Note: Drying the faucet with a soft cloth after each use will prevent mineral deposits.*

How do I remove mineral deposits from the aerator?

- **Unscrew** the aerator.
- **Remove** it and the black sealing gasket above it.
- **Rinse** the gasket in clean water.
- **Soak** the aerator in a 50/50 vinegar and water solution for several hours.
- **Flush** the aerator with water.
- **Rub** stubborn deposits with a toothbrush.

How do I clean/remove mineral deposits from my pull-out/pull-down wand, showerhead or handshower?

The face of your pull-out/pull-down wand, showerhead or handshower incorporates **Touch-Clean**® technology by Delta®. To ensure proper spraying, follow these steps:

- **Wipe** over the rubber-like spray holes on your Touch-Clean pull-out/pull-down wand, showerhead or handshower face, using your fingertips to loosen and break away residue and mineral deposits.

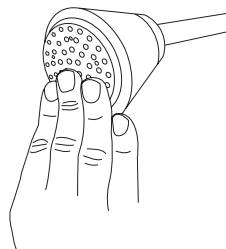
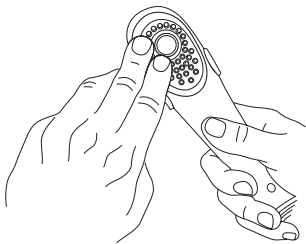

For a Deeper Cleaning:

- **Unscrew** the showerhead, handshower or wand.
- **Soak** it in a 50/50 vinegar and water solution for several hours.
- **Rub** stubborn deposits with a toothbrush.

New technologies.

DIAMOND™ Seal Technology

DIAMOND Seal Technology, created by Delta®, uses a valve with a tough diamond coating to bring you a faucet built to last up to five million uses—plus, once water enters the faucet, it is not in contact with potential metal contaminants.



Longer lasting.
The DIAMOND™ Valve lasts up to 10 times longer than the industry standard.
Industry standard based on ASME A112.18.1 = 500,000 cycles

Lead-free.
Once inside the faucet, water is not in contact with potential metal contaminants.



Less hassle.
All the parts needed for installation are in the box. No risers required. DURAMOUNT™ mounting system provides durable, fast and corrosion resistant installation.

Includes 3/8" stop connections.
Adapters may be required for other stop configurations.



Leak free.
The threat of leaks is all but eliminated thanks to the exclusive one-piece InnoFlex® PEX supply lines, DIAMOND Valve and no dynamic seals. The patented DIAMOND Valve eliminates leaks and drips from the valve.

How do I set the handle limit stop on my DIAMOND Seal Technology faucet?

DIAMOND Seal Technology faucets that were produced after October 1, 2008, feature a two-function handle limit stop. The handle limit stop—which enables you to limit movement of the handle, so it cannot move to the full on hot position—offers the choice of two settings:

1. Full range of handle motion (this option is pre-set at the factory).
2. A stop option that restricts handle motion to a 50/50 mix of hot and cold water.*

To Change Your Handle Limit Stop Setting to a 50/50 Mix of Hot and Cold Water:

- **Remove** handle.
- **Move** the orange switch to the half circle setting.



*The handle stop limit should not be considered an anti-scald device.

New technologies.

Touch₂O® Technology

The intuitive Touch₂O Technology developed by Delta® allows you to turn the faucet on or off with just a touch—anywhere on the faucet's body or handle.

What if my Touch₂O faucet handle or spout doesn't respond to touch?

Depending on the possible cause, different solutions may work. Try the tips below. You may not need to go through each of these steps to correct the problem.

- **Check** the batteries/power.
- **Check** the handle to make sure it is in the ON position.
- **Use** a deliberate touch like playing a piano. The touch should not be: (1) too long; (2) too short; (3) with fingernails; (4) or with a dry cloth.
- **Check** the Maintenance and Installation sheet—which can be found by visiting deltafaucet.com and searching for your faucet model—to ensure proper installation of all electrical connections and spout insulating elements.
- **Reset** the unit by disconnecting the battery or power supply; wait 30 seconds and re-connect battery or power supply.

What if my LED does not come on?

- **Replace** the batteries.

What if my faucet is not responding to touch and the manual handle doesn't turn on the water?

- **Contact 1-800-345-DELTA (3358)** to speak with Delta customer service or visit deltafaucet.com to review the information in the Maintenance and Installation Sheet section for your model.

For more information about Touch₂O Technology by Delta, visit deltafaucet.com/touch. The Touch₂O Technology User's Guide—which can be downloaded from the site—provides additional details about using and maintaining your kitchen faucet with Touch₂O Technology.



Before you call.

To follow you'll find some frequently asked questions and troubleshooting tips. For more information on any topic—or to find information on a problem you don't see here—visit deltafaucet.com/customersupport where you can search for more detailed instructions.

What should I do if my single-handle kitchen or lavatory faucet drips from the spout?

Your Delta® faucet is designed for leak-free performance, and all of our faucets are performance-tested before they leave our manufacturing facilities. If you experience a drip from the spout, follow the Early Maintenance instructions on page 3 of this guide. If you continue to experience the problem, follow these steps:

For Single-Handle Faucets, First:

- **Remove** the handle to determine what type of valve is inside.
- **Look** for an orange handle limit stop. If you have an orange handle limit stop, you have a DIAMOND™ Seal Technology valve. If you don't have an orange handle limit stop, you most likely have a ball valve.

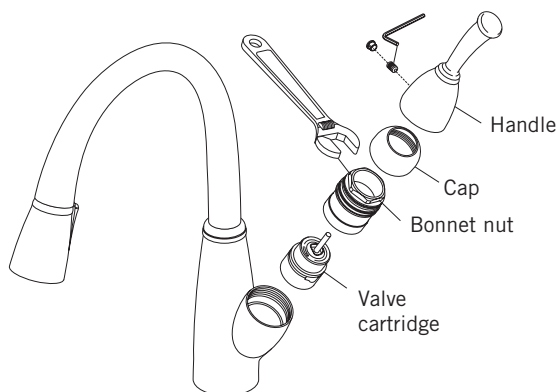

For DIAMOND Seal Technology Models:

- **Unthread** cap.
- **Use** a wrench to tighten the bonnet nut.
- **Replace** the handle.
- **Contact 1-800-345-DELTA (3358)** or visit deltafaucet.com/customersupport for assistance if you continue to experience issues.

For Ball Valve Models:

- **Replace** the seats and springs—which can become worn through normal use, depending on the water conditions in your area. To obtain replacement seats and springs, call **1-800-345-DELTA (3358)** or visit a local Delta Genuine Parts dealer.
- **Go to deltafaucet.com/customersupport** and choose the appropriate link or use the search tool for complete instructions on how to replace your faucet's seats and springs.

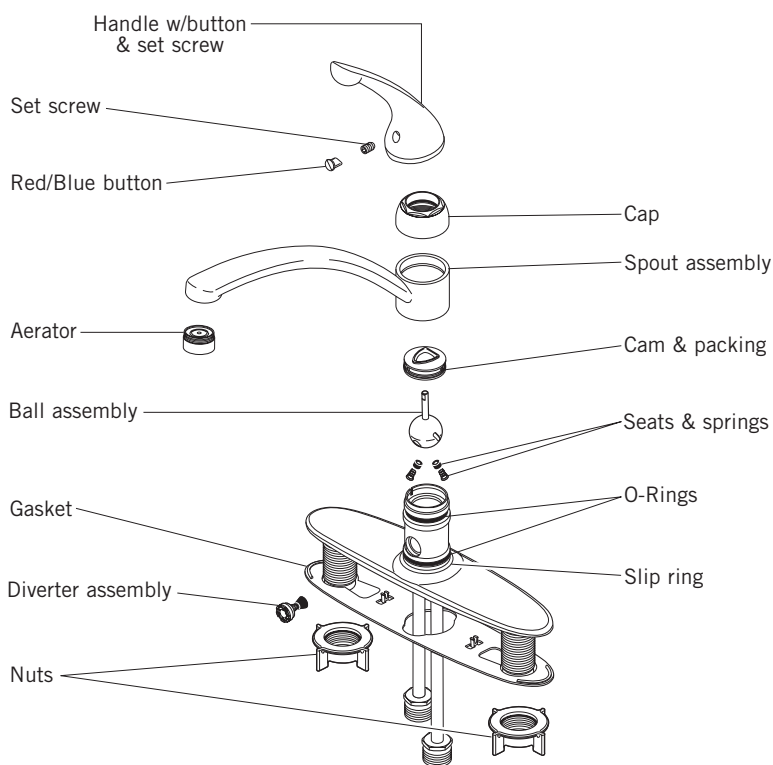

Before you call.

What should I do if my two-handle kitchen or lavatory faucet drips from the spout?

- **Follow** the Early Maintenance instructions on page 3 of this guide.
- **Replace** the seats and springs in the handle assemblies if the faucet continues to drip. To obtain replacement seats and springs, call **1-800-345-DELTA (3358)** or visit a local Delta® Genuine Parts dealer.
- **Visit deltafaucet.com/customersupport** and choose the appropriate link or use the search tool for complete instructions on how to replace your faucet's seats and springs.

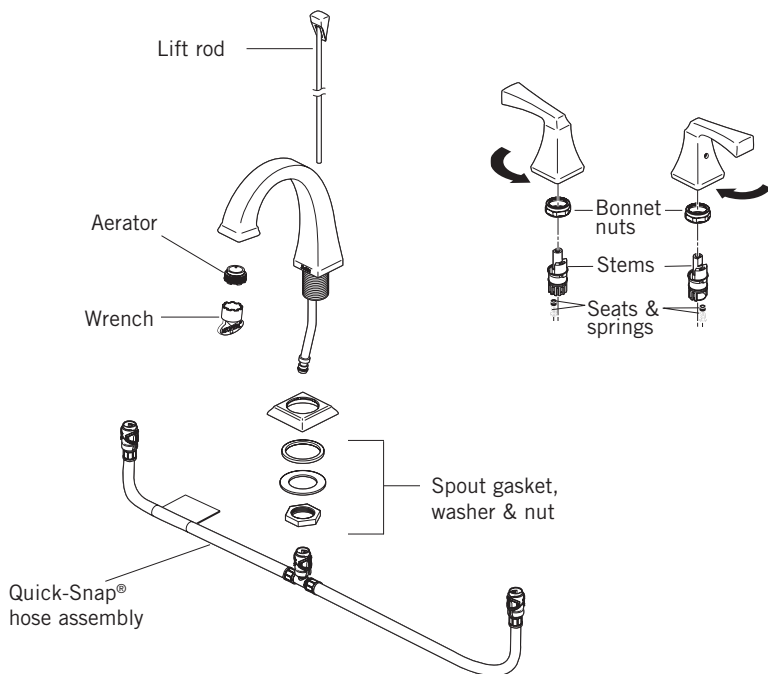

What should I do if my single- or two-handle faucet leaks under the handle?

- **Remove** the handle. (For DIAMOND™ Seal Technology models, also remove the cap.)
- **Use** an adjustable wrench or channel locks to tighten the bonnet nut (on two-handle models and single-handle DIAMOND™ Seal Technology models), or use a strap wrench to tighten the cap (on single-handle models). If you don't have a strap wrench, put a towel over the cap to protect the finish and use channel locks.
- **Replace** the handle.

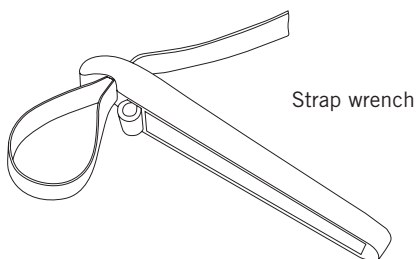

If that does not solve the problem, you may need to replace the cam assembly for a single-handle faucet with a ball valve (see illustration on page 12), or the stem unit assembly for a two-handle faucet (see illustration below). For DIAMOND Seal Technology models, you may need to replace the DIAMOND™ Valve. Visit deltafaucet.com/customersupport for quick and easy fix information.

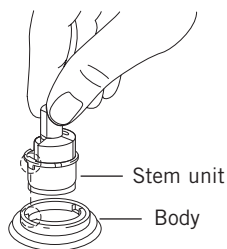
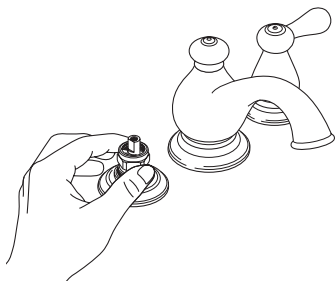

Before you call.

My two-handle widespread faucet is dripping underneath the counter. How can I fix it?

It is extremely rare for a faucet to develop a leak under the counter. Delta® widespread faucets feature Quick-Snap® installation. If you have Quick-Snap connections and experience leaking at the connection points, Quick-Snap may not have been properly installed. Visit deltafaucet.com/customersupport for detailed information on how to properly engage your Quick-Snap connections—or to find out how to solve the issue if your faucet does not have Quick-Snap connections.

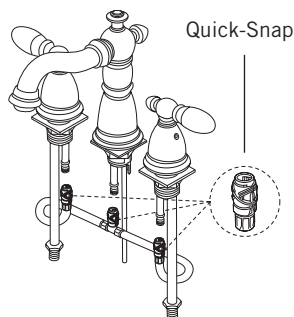

What if water isn't flowing normally from my showerhead?

If you notice a performance issue, there may be debris caught in your showerhead. Follow these steps to solve:

- **Unscrew** showerhead from arm.
- **Turn** on water and run for 30 seconds to flush the shower arm.
- **Remove** black/gray debris screen.
- **Rinse** screen with water.
- **Soak** showerhead in a 50/50 vinegar and water solution for several hours.
- **Replace** debris screen.
- **Reinstall** the showerhead on the arm using plumber tape.
- **Turn** handle(s) to full on hot and cold mixed position(s), and flush water through the showerhead for several minutes.

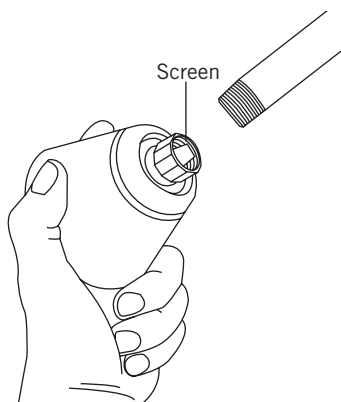

Smart features.



DIAMOND™ Seal Technology

Diamonds are the hardest substance known to man, and DIAMOND Seal Technology takes full advantage of this property. Exclusively from Delta, DIAMOND Seal Technology uses a valve with a tough diamond coating to bring you a faucet built to last up to five million uses—plus, once water enters the faucet, it remains out of contact with potential metal contaminants.



Smart features.



Touch₂O® Technology

The intuitive Touch₂O Technology developed by Delta® allows you to turn the faucet on or off with just a touch—anywhere on the faucet's body or handle.

- **Simple:** A simple tap anywhere on the spout or handle intuitively turns the faucet on and off.
- **Clean:** When hands get messy, you can start the flow of water with a forearm or wrist, minimizing the spread of dirt and germs.
- **Efficient:** Touch₂O Technology enables you to turn the faucet on and off with just a tap, making kitchen tasks easy during food prep and clean up.
- **Water Efficient:** The tap feature makes it easier to turn off the water flow when it's not needed between tasks, saving water.





H2Okinetic Technology®

Proprietary H2Okinetic Technology by Delta uses larger water drops to create a warmer, more luxurious shower experience that blankets the body, making less water feel like more. With larger droplets that retain their heat longer for a massaging effect, and a denser spray pattern for a feeling of drenching coverage, you will be enveloped in the warmth of the water.



MultiChoice® Universal

Flexibility is the big benefit of MultiChoice Universal. Once the MultiChoice Universal tub/shower valve is installed, future shower functionality upgrades or style changes can be made easily—without altering the plumbing behind the wall.



WaterSense®-Labeled Lavatories

All Delta WaterSense-labeled lavatories flow at 1.5 gallons per minute (gpm)—a 32% savings versus the industry standard*—without sacrificing the comfort and convenience of the user experience or the durability and life span of the product.

**Industry standard ASME.A112.18.1/CSA.B125.1 of 2.2 gpm*



MagnaTite™

Delta-exclusive MagnaTite docking keeps the kitchen pull-down spray wand firmly in place with a powerful integrated magnet, so it stays neatly in place when not in use.



Brilliance® Finishes

Delta *Brilliance* finishes, like the popular *Brilliance* Stainless, are developed using a patented process called Physical Vapor Deposition (PVD). *Brilliance* molecules are embedded deep into the faucet's surface, creating a long-lasting bond. These beautiful finishes—which won't corrode, tarnish or discolor—are designed to look like new for life.



Touch-Clean®

Delta Touch-Clean soft, rubber spray holes allow you to easily wipe away calcium and lime build-up from the spray face of your showerhead, handshower or kitchen faucet sprayer—with just the touch of a finger.

Faucet and finish lifetime limited warranty.

Delta Faucet Company products are warranted to the original consumer purchaser. Please refer to the warranty enclosed with each Delta® product for specific details. Additional copies are available upon request.

Have a question or need assistance?

Please call **1-800-345-DELTA (3358)** and one of our Customer Resource Representatives will be glad to help you.

And don't forget to register your faucets at **deltafaucet.com/warranty**.

For more detailed care and maintenance information, visit **deltafaucet.com/customersupport**.

WaterSense is a registered trademark of the U.S. Environmental Protection Agency.

A MASCO COMPANY

Delta Faucet Company
55 E. 111th St., P.O. Box 40980
Indianapolis, IN 46280

Masco Canada Limited, Plumbing Group
395 Matheson Blvd. East
Mississauga, Ontario L4Z 2H2

deltafaucet.com
800.345.DELTA (3358)

©2009 Masco Corporation of Indiana
DL-1619A 10/09

